

Attach butterfly corners to either side of extension, trim as necessary (band, sealant, and support not shown for clarity)

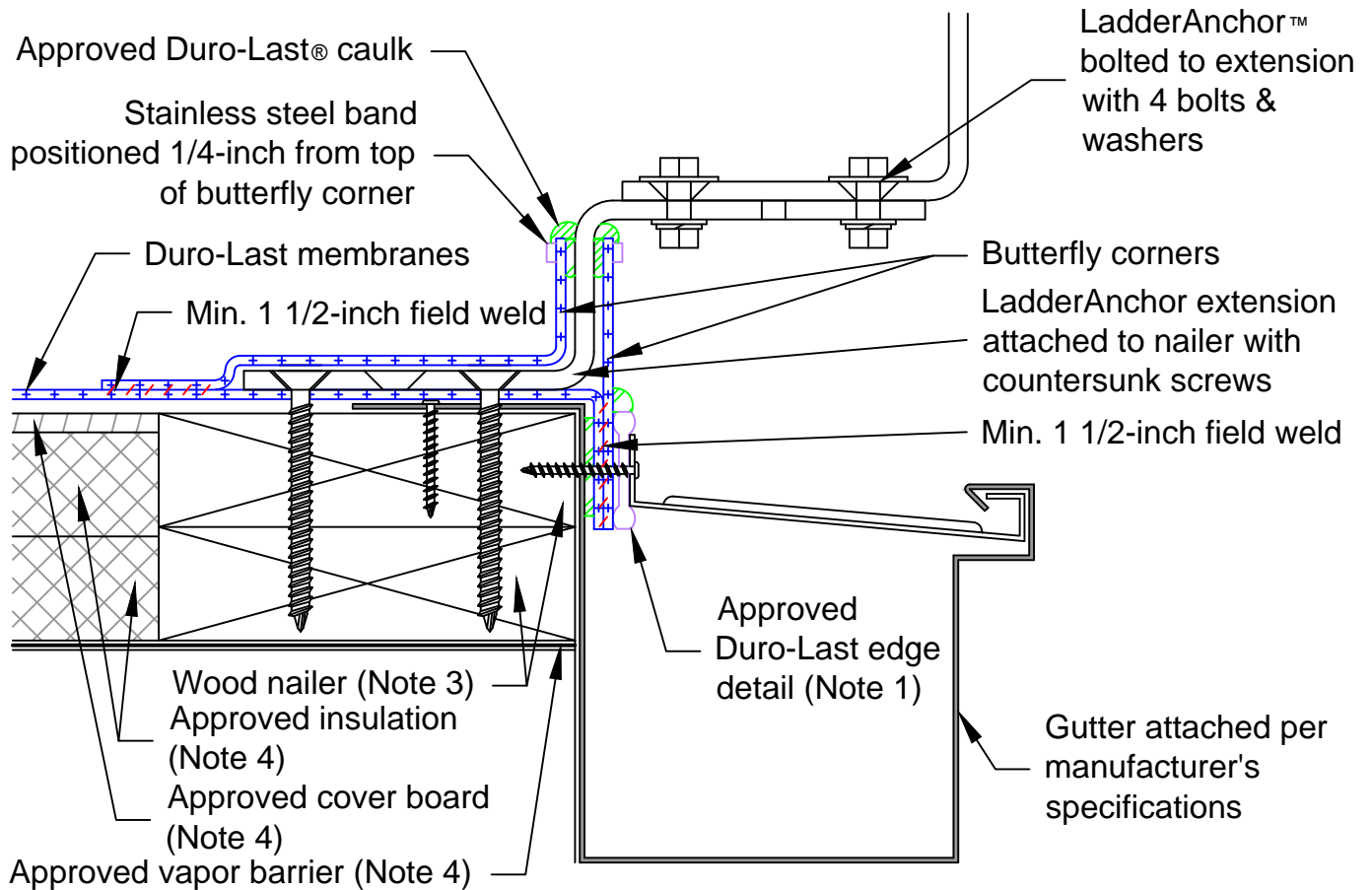
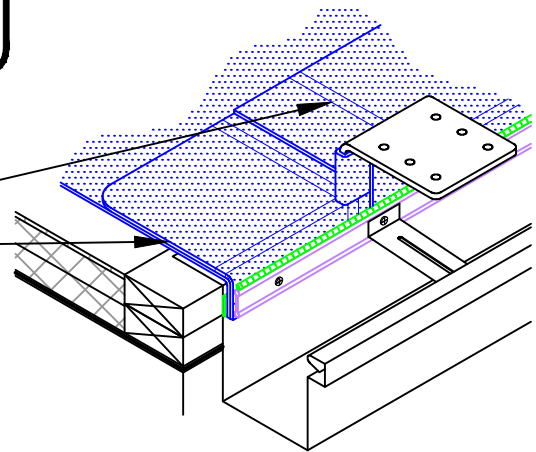

Note 1: Appropriate Duro-Last termination must be followed.

Note 2: Wood blocking must be installed below support if insulation is used.

Note 3: Wood nailers must withstand a minimum force of 180 pounds per lineal foot (per building code). Any pull values greater than 270 pounds will allow for a fastener spacing of 18 inches on center. Pull values less than 270 pounds will require additional fasteners. **The installing contractor is responsible for meeting building codes.**

Note 4: Refer to specifications for vapor barrier, insulation and cover board requirements.

REVISED:	N/A	ROOF PENETRATION DETAIL FOR MECHANICALLY FASTENED SYSTEMS
PREVIOUS:	01/28/2017	LADDERANCHOR™ EXTENTION
SCALE:	NONE	NEW CONSTRUCTION OR RE-ROOF