

# CORRECT

Fastener driven perpendicular

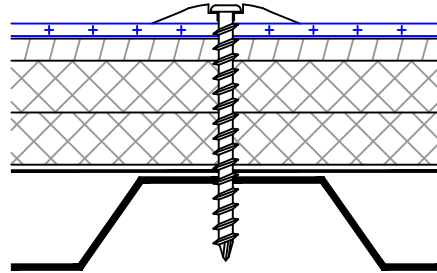

Overlapping membrane not shown for clarity of details.

# INCORRECT

Fastener snapped

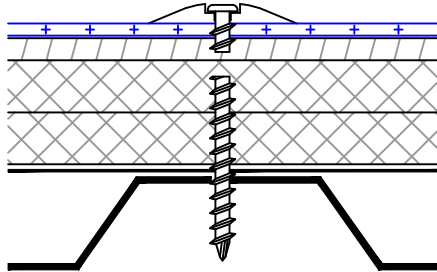

Fastener bent

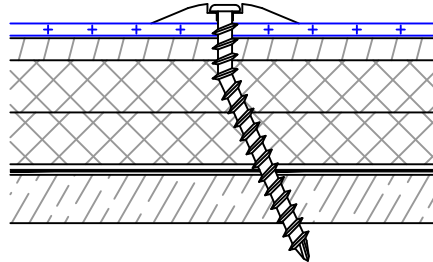

Fastener underdriven

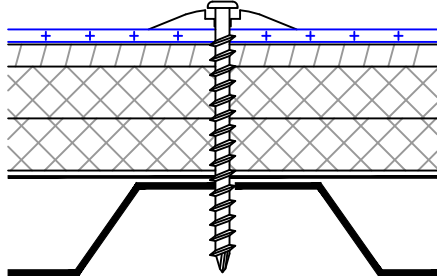

Fastener overdriven

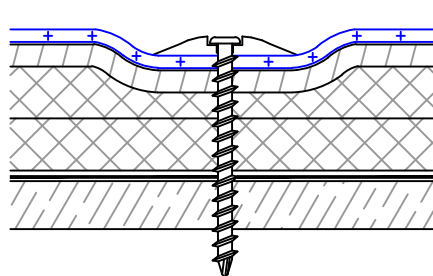

Fastener driven at an angle

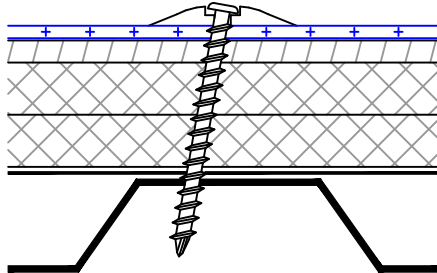

Note 1: Fasteners may penetrate through the top or bottom flute of metal decks.

Note 2: Fasteners must penetrate metal, wood and structural concrete decks by 1 inch, measuring down from the top of the deck.

REVISED: 01/30/2017	GENERAL DETAIL FOR MECHANICALLY FASTENED SYSTEMS
PREVIOUS: 01/01/2009	FASTENING INTO METAL AND WOOD DECKS
SCALE: NONE	NEW CONSTRUCTION OR RE-ROOF